

£1,300 Per Month

Cranleigh Road, Portsmouth PO1
5LX

bernards
THE ESTATE AGENTS



HIGHLIGHTS

- ❖ TWO BEDROOM FAMILY HOME
- ❖ IMMACULATE CONDITION
- ❖ TWO RECEPTION ROOMS
- ❖ LARGE KITCHEN
- ❖ DOUBLE BEDROOMS
- ❖ MODERN THROUGHOUT
- ❖ BUILT IN STORAGE
- ❖ LOW MAINTENANCE GARDEN
- ❖ AVAILABLE MAY
- ❖ EPC RATING C

Nestled on Cranleigh Road in Portsmouth, this immaculately presented two-bedroom family home offers a perfect blend of modern living and comfort. As you step inside, you are greeted by two reception rooms that provide ample space for relaxation and entertaining. The contemporary design flows seamlessly throughout the property, ensuring a bright and inviting atmosphere.

The double bedrooms are generously sized, featuring built-in storage that

maximises space and keeps your living areas tidy. The well-appointed bathroom adds to the home's appeal, providing a stylish and functional space for your daily routines.

This delightful house is ideal for families or couples seeking a modern lifestyle in a welcoming neighbourhood. Don't miss the opportunity to make this lovely house your new home.

Call today to arrange a viewing
02392 728090
www.bernardsea.co.uk





Call today to arrange a viewing
02392 728090
www.bernardsestates.co.uk



PROPERTY INFORMATION



Energy Efficiency Rating		Current	Potential
Very energy efficient - lower running costs			
(92 plus) A			
(81-91) B			
(69-80) C			
(55-68) D			
(39-54) E			
(21-38) F			
(1-20) G			
Not energy efficient - higher running costs			
		69	85
England & Wales		EU Directive 2002/91/EC	

Scan here to see all our properties for sale and rent



GROUND FLOOR
447 sq.ft. (41.5 sq.m.) approx.

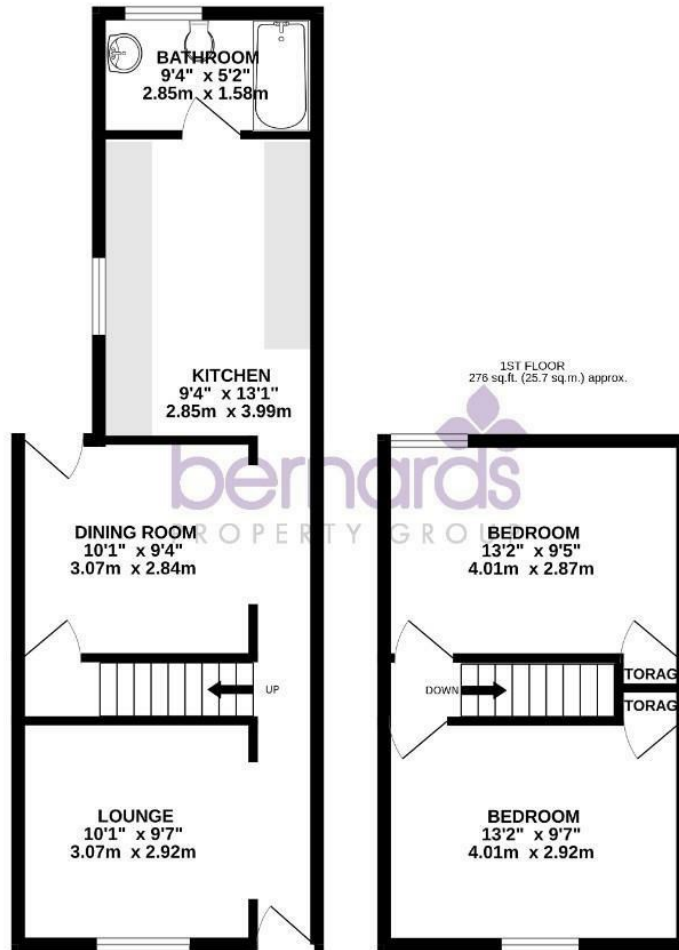

TOTAL FLOOR AREA : 724 sq.ft. (67.2 sq.m.) approx.

Whilst every attempt has been made to ensure the accuracy of the floorplan contained here, measurements of doors, windows, rooms and any other items are approximate and no responsibility is taken for any error, omission or mis-statement. This plan is for illustrative purposes only and should be used as such by any prospective purchaser. The services, systems and appliances shown have not been tested and no guarantee as to their operability or efficiency can be given.
Made with Metroplan ©2026

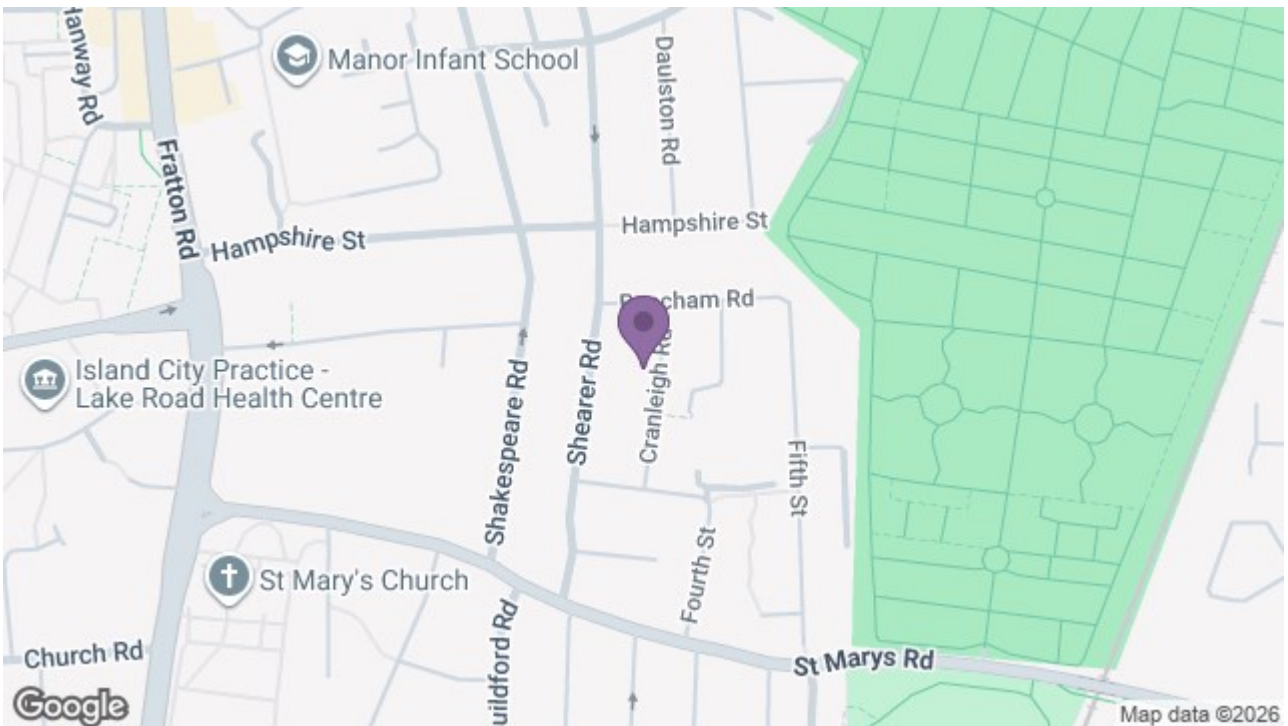

129 London Road, Portsmouth, Hampshire, PO2 9AA
t: 02392 728090

